



Your shell of comfort

www.omaya-yachts.com















VISION

Our mission is to design and build luxurious catamarans that seamlessly blend home comfort, unparalleled space, and superior performance, making every journey feel like home. We aspire to become a leading producer of high-value yachts, renowned for delivering luxurious experiences and unmatched build quality. By integrating the latest innovations in eco-friendly materials, resource management, propulsion, and digital automation, we create yachts that offer timeless aesthetics, modern design, and an emotionally fulfilling yachting experience.

A woman with long dark hair, wearing sunglasses and a white long-sleeved shirt with a striped halter, is steering a white catamaran. The boat is on the water, and the background shows a sunset over a distant shoreline with hills and buildings. The interior of the boat, including the steering wheel and dashboard, is visible in the foreground.

 OMA YA 50



Experience unparalleled comfort, autonomy, and year-round cruising with the Omayya 50

The OMAYA 50 is a 50-foot luxury catamaran with a sleek, contemporary design that offers exceptional onboard living. Its standout feature is an industry-leading 8.4-meter beam, which provides expansive space throughout the yacht, including the lower deck, cabins, and a generously sized saloon. This spaciousness ensures that families and guests enjoy a home-like atmosphere with a fully equipped galley, ample seating, both indoors and outdoors, and even dedicated space for crew members. The OMAYA 50 delivers comfort, style, and functionality in every detail.



OMAYA

50

Your shell of comfort



OMAYA 50



Luxury power catamarans designed to
redefine your relationship with the ocean.

OMA YA 50

The extraordinary flybridge on the OMA YA 50 offers exceptional functionality and comfort. It features a spacious seating area with versatile high/low tables that can be used as coffee tables or dining place, accommodating up to 12 people. The flybridge also includes large sunbeds with ample storage beneath, a wet bar with a fridge, icemaker or wine cooler, grill, and a sink. Additionally, the helm station is equipped with the latest navigation systems and offers seating for two, making this area perfect for both relaxation and navigation.



FLY BRIDGE





The OMAVA 50 is designed with you in mind

The bow area of the OMAVA 50 is truly special. Thanks to the yacht's wide beam and thoughtful, customer-focused layout, it's an ideal spot to spend lazy days soaking up the sun and entertaining friends. With a comfortable seating area and large sunbeds, the bow is perfect for relaxation and socialising. The addition of a direct access door from the saloon enhances both safety and convenience. All these features make the OMAVA 50 an exceptional choice for holidays or extended living on the water.

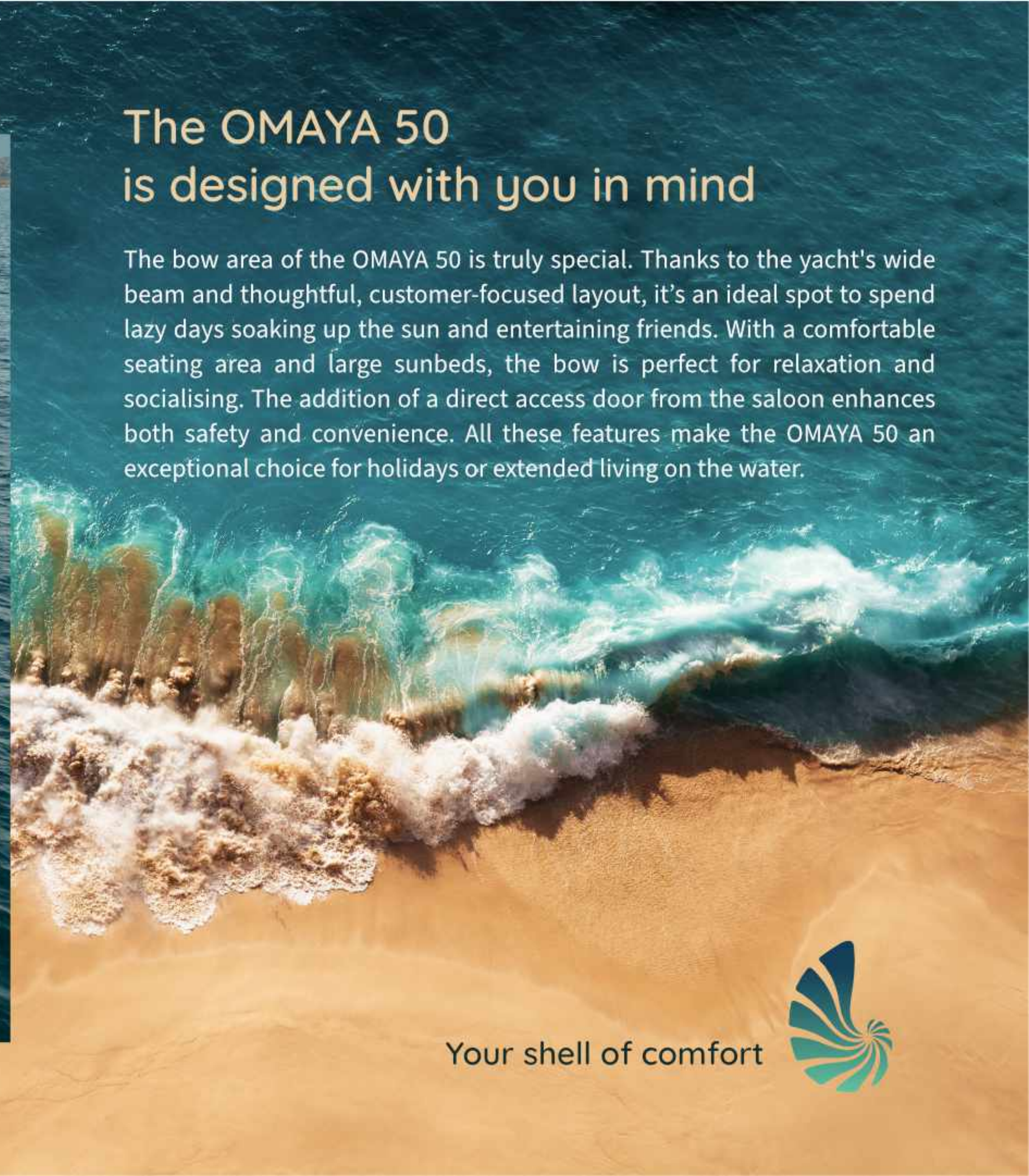

Your shell of comfort





The OMAYA 50 is the result of years of dedicated development, designed to meet modern needs with a perfect balance of comfort and safety. It's more than just a yacht; it becomes your home, piercing through the waves, allowing you to embark on long-term escapes and explore the world in a way you never have before. With the OMAYA 50, every journey is an invitation to adventures and create new memories.





One of the defining traits of OMAA Yachts is the luxurious, all-season saloon. Whether you're sailing in hot summer or cooler spring and autumn, OMAA ensures comfort for all passengers. The spacious saloon is equipped with panoramic windows, a fully outfitted galley featuring a double-door fridge and 4-hob cooktop, a full-size dining table, a cozy sofa, and a retractable 50-inch TV. This space creates the perfect setting for relaxation and entertainment, no matter the weather.

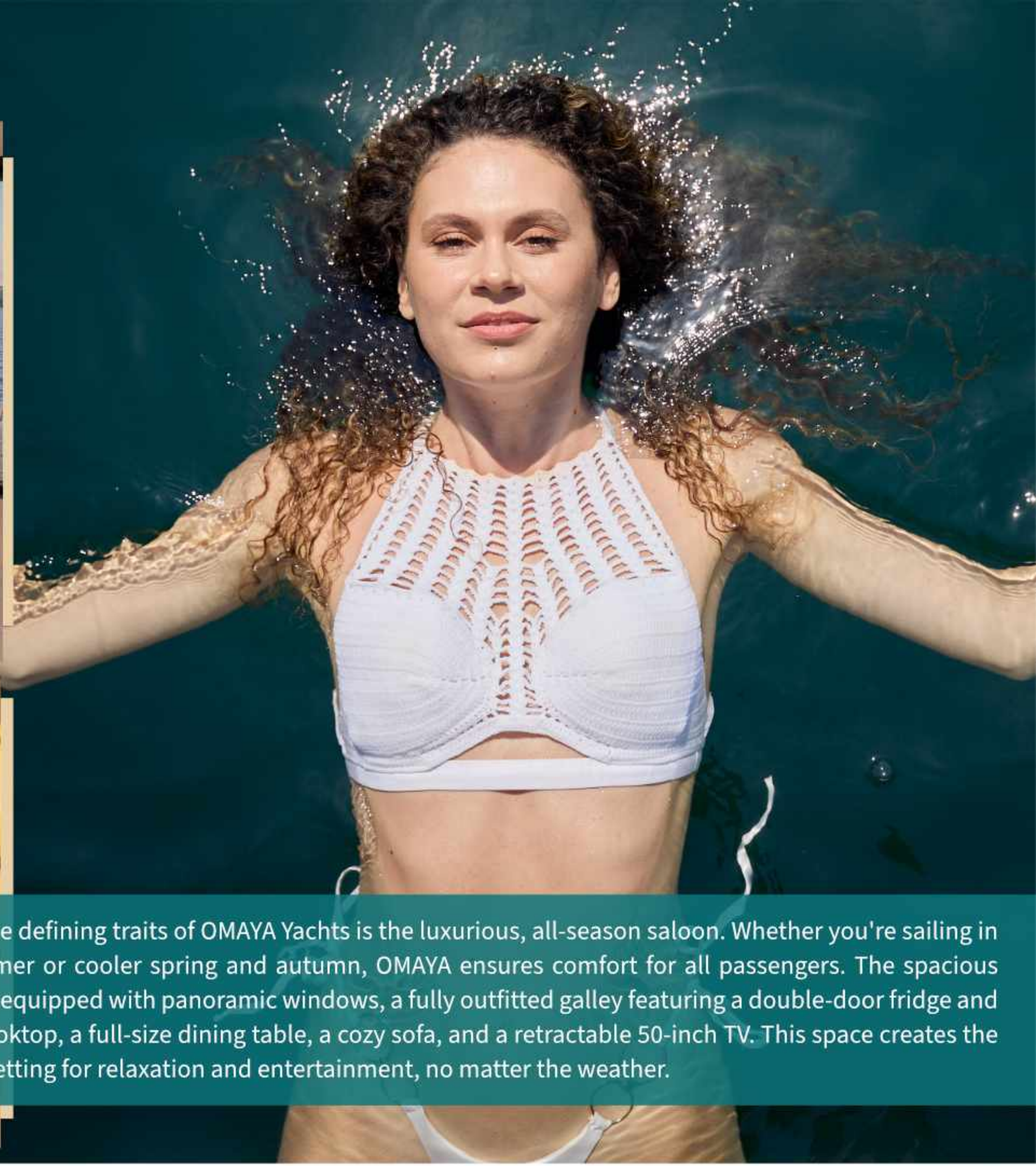



OUTDOOR COCKPIT

The aft cockpit of the OMAYA 50 is an ideal spot for enjoying a leisurely brunch with stunning infinity ocean views. It features ample storage for tables with sturdy removable legs and foldable chairs. The versatile high-low hydraulic platform extends the deck area or provides easy access to the water, making this space perfect for all-day fun and games at sea. This design ensures the cockpit is both practical and enjoyable, enhancing your overall yachting experience.





SALOON

The dining area features a versatile high/low table that comfortably seats ten guests. Expansive glass doors span the entire width of the saloon, creating an open and inviting atmosphere and offering stunning ocean views.





 Omayya 50

DINING AREA

The dining area with high/low table can seat 10 guests in comfort while enjoying incredible views of the ocean through the large glass doors that extend the entire width.



MASTER CABIN



MASTER BATHROOM



OMayA 50

The OMayA 50 features a spacious lower deck with two layout options. The owner's version includes a large master cabin occupying the entire port side, complete with a double bed, sofa, desk, vanity area, integrated wardrobe, and a luxurious ensuite. On the starboard side are two additional double guest cabins, each with ensuite bathrooms and integrated wardrobe space. An additional crew cabin is located in the starboard forward peak, while a crew bathroom can be found in the port forward area, ensuring convenience and privacy for the crew on board.

OMA YA 50

The charter version of the OMA YA 50 offers four double guest cabins, each with ensuite bathrooms. These cabins, located on both the port and starboard sides, are luxuriously appointed with spacious beds, integrated wardrobe space, and ambient lighting. To ensure a best-in-class charter experience, the OMA YA 50 can be equipped with accommodations for two crew members, with their cabins conveniently located in the forward peaks on both the port and starboard sides.



VIP CABIN



GUEST CABIN





OMAYA 50

TECHNICAL SPECIFICATIONS

Model	OMAYA 50
Length overall	14,98m / 49.1ft
Length waterline	14,27m / 49.1 ft
Beam overll	8,39 m / 27.5ft
Height above waterline w / hard top	6,94m / 22,7ft
Draft	1,05m / 3,4ft
Unloaded weight / Light displacement (approx.)	20,5t / 45,195lbs
Engines	2x YANMAR 4LV 320 HP 2x YANMAR 6LV 440 HP
Fuel tank	2 x 850l 2 x 225gal
Fresh water capacity	2 x 320l 2 x 85gal
Black / Gray water capacity	1 x 125l, 1 x 260l / 2 x 165l 1 x 33gal, 1 x 67gal / 2 x 44gal
Cabins (Up to)	4+2
Heads (Up to)	4+1
Showers (Up to)	4+1
CE Certification	A:12 B:14 C:20 D:24

OMAYA 50 LAYOUT
BIMINI

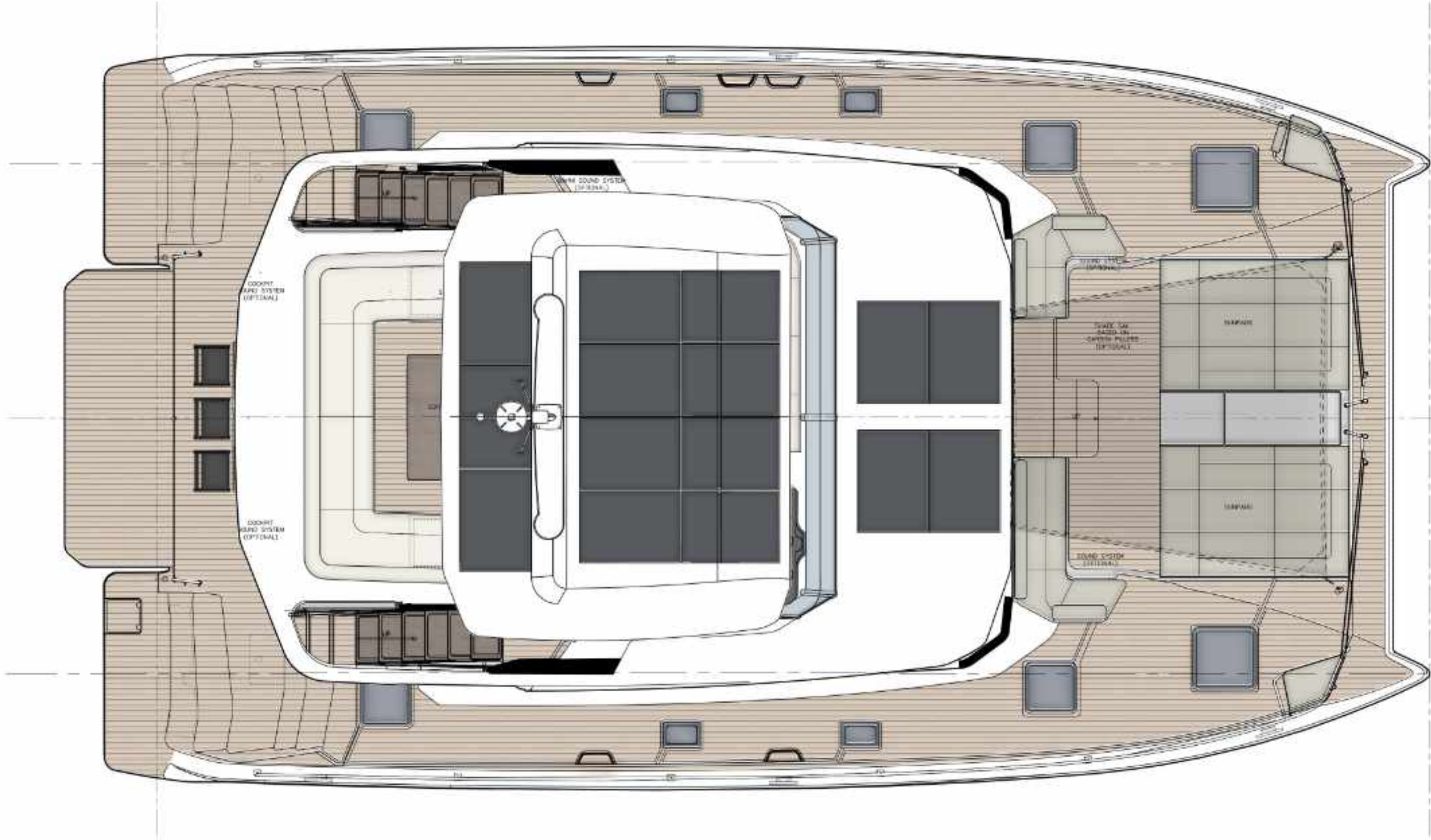

OMAYA 50 LAYOUT

FLYBRIDGE

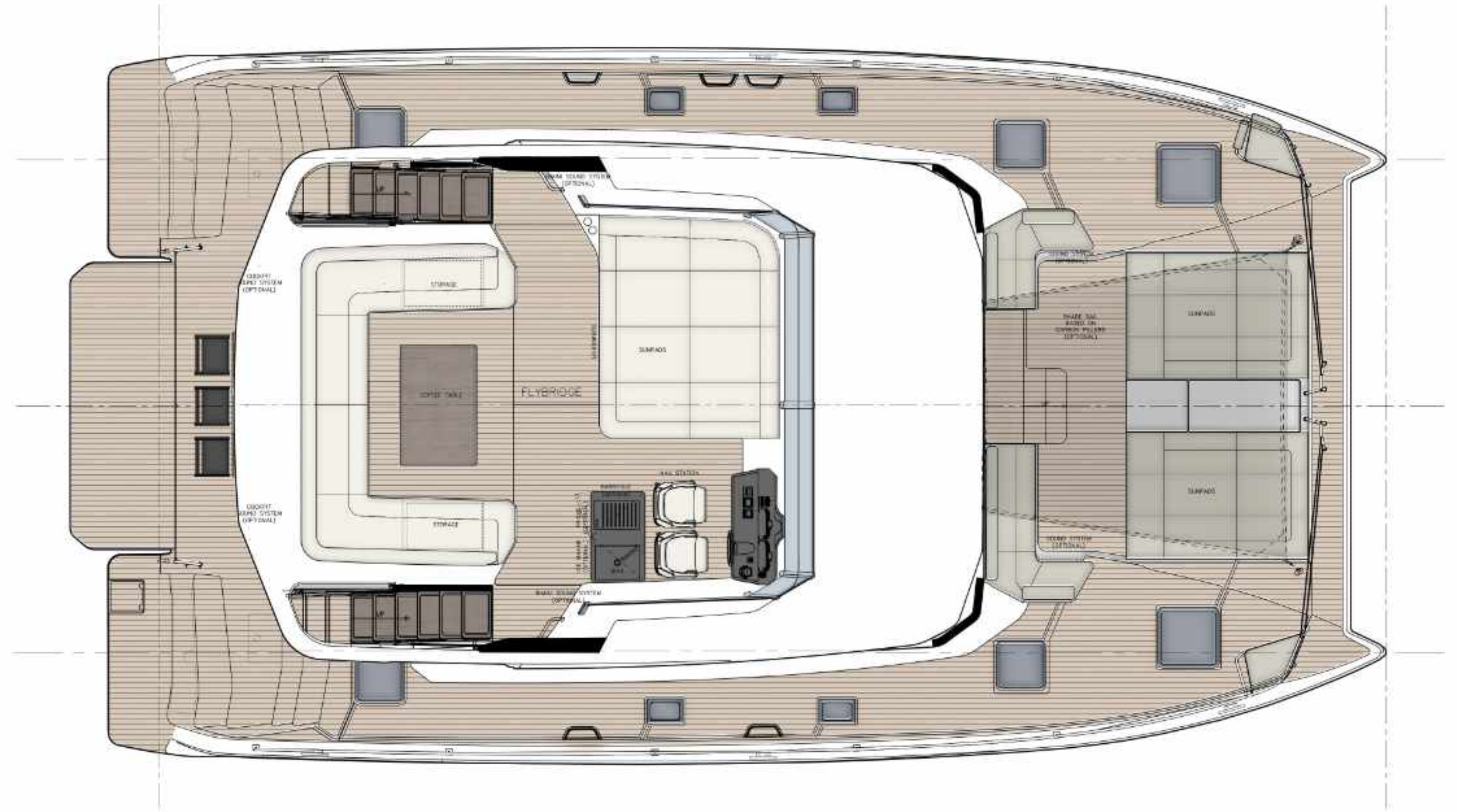

OMAYA 50 LAYOUT

MAIN DECK

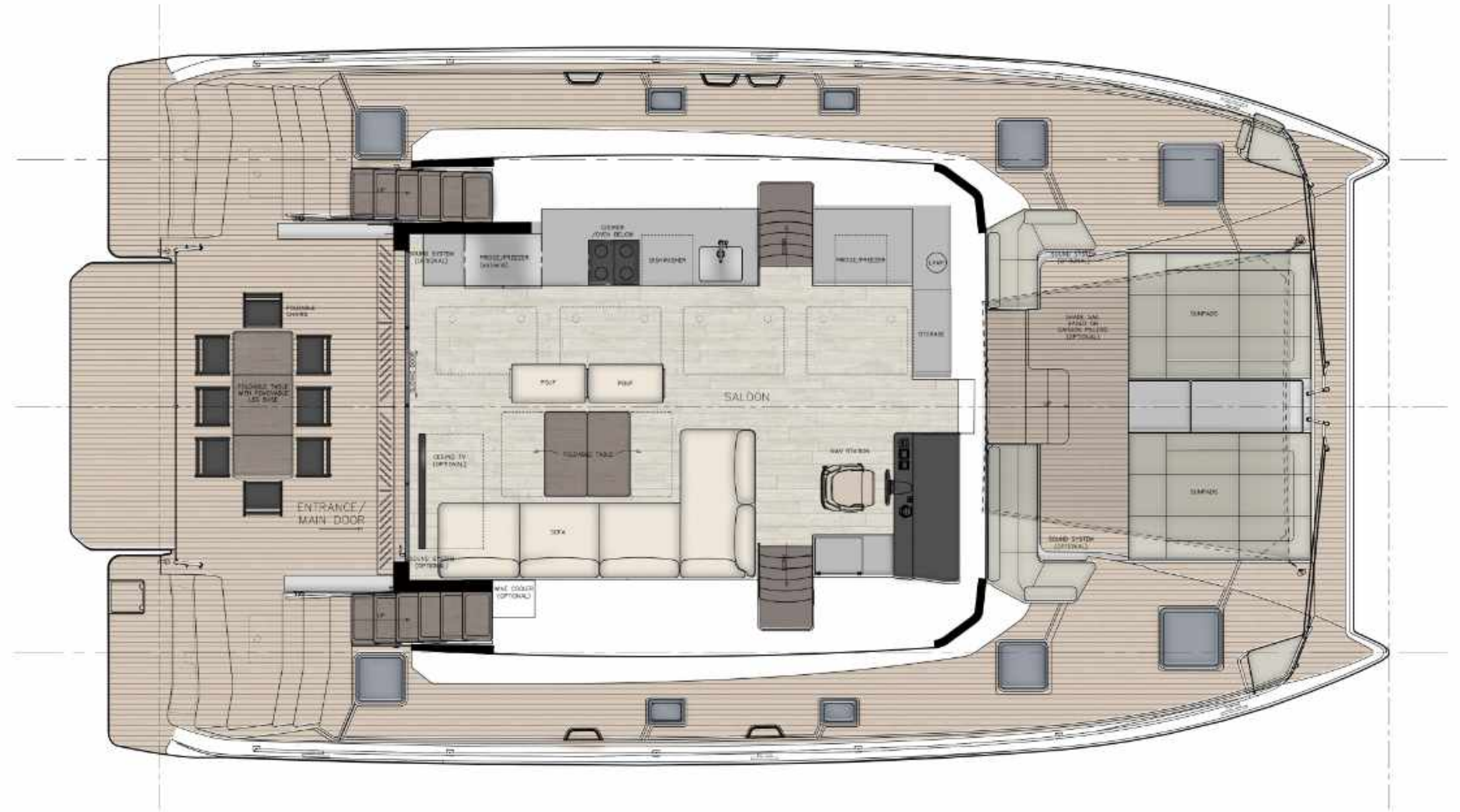

OMAYA 50 LAYOUT

3 CABIN HULLS

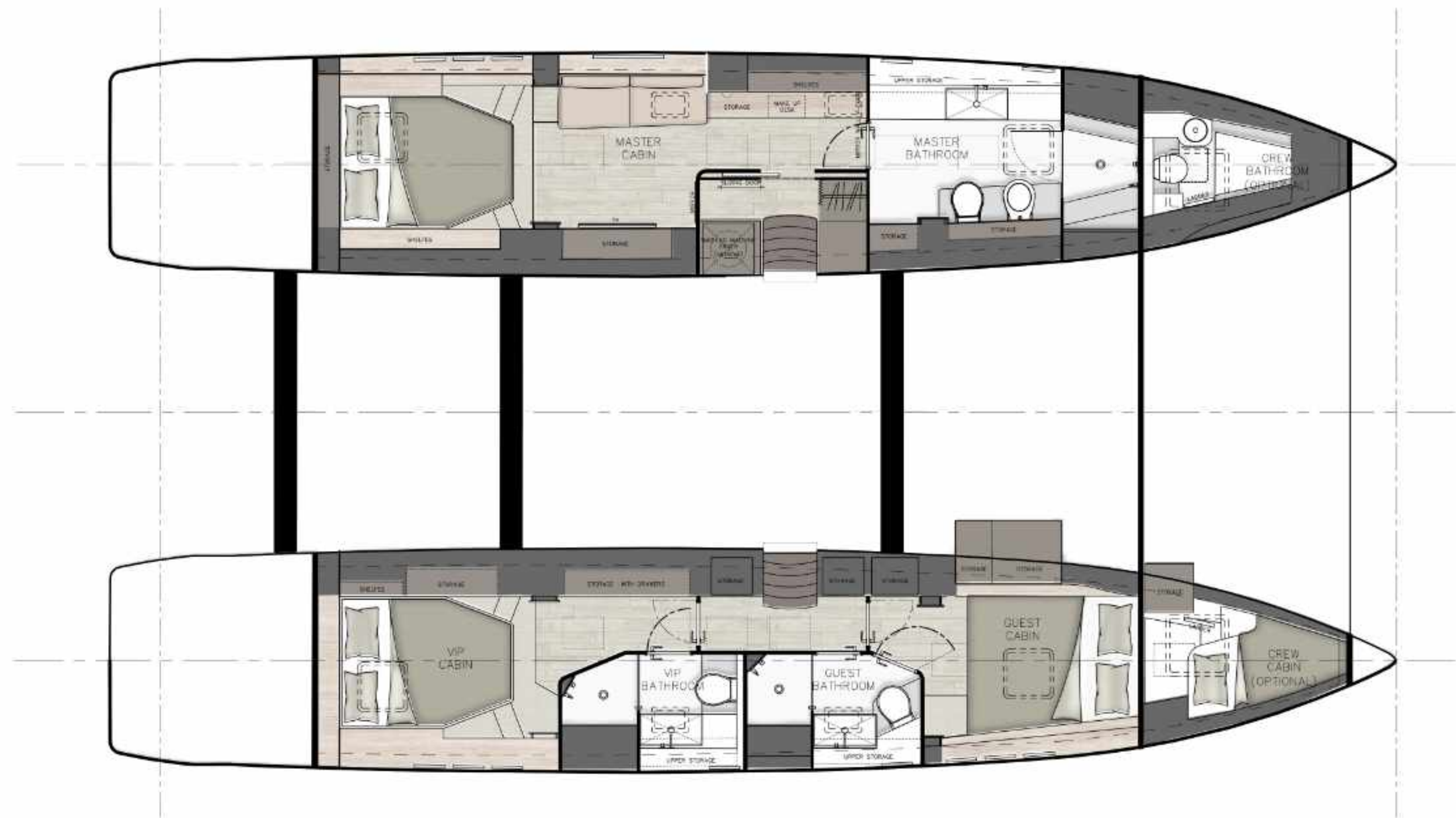

1 Master cabin, 1 VIP cabin, 1 Guest cabin
1 Crew cabin (optional)

OMAYA 50 LAYOUT

4 CABIN HULLS

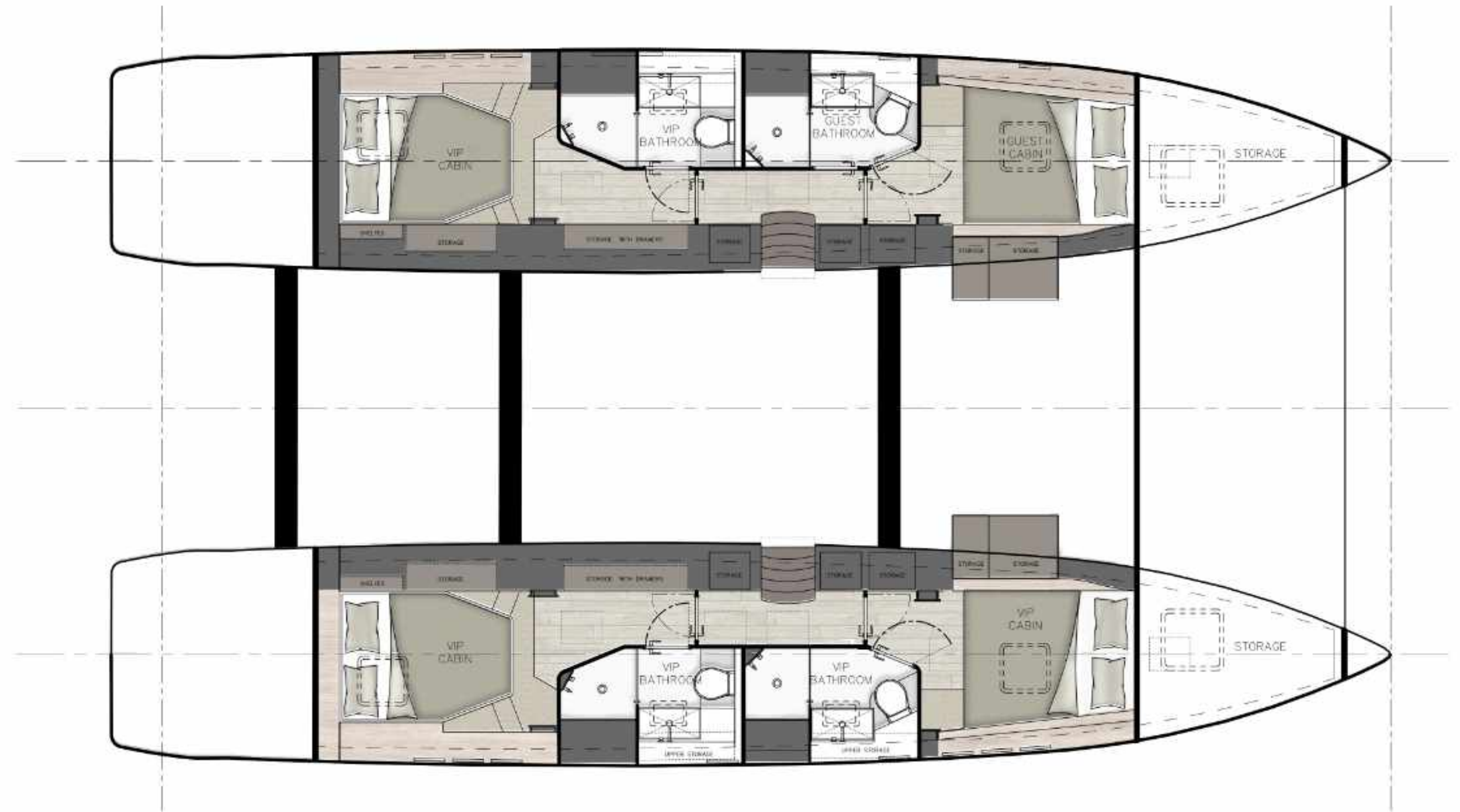

3 VIP cabins, 1 Guest cabin

OMAYA 50 LAYOUT

4 CABIN HULLS

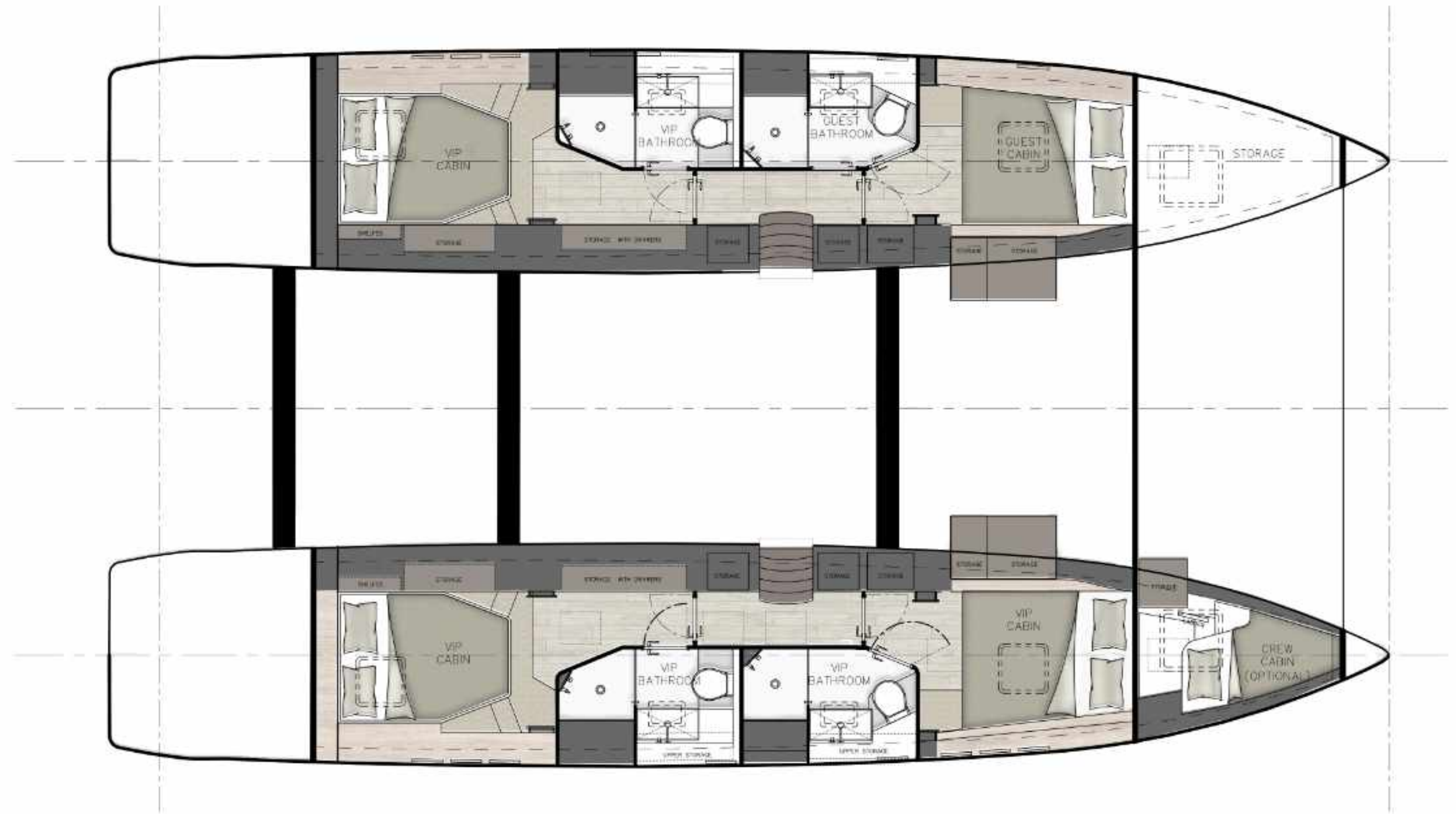

3 VIP cabins, 1 Guest cabin
1 Crew cabin (optional)

OMAYA 50 LAYOUT

4 CABIN HULLS

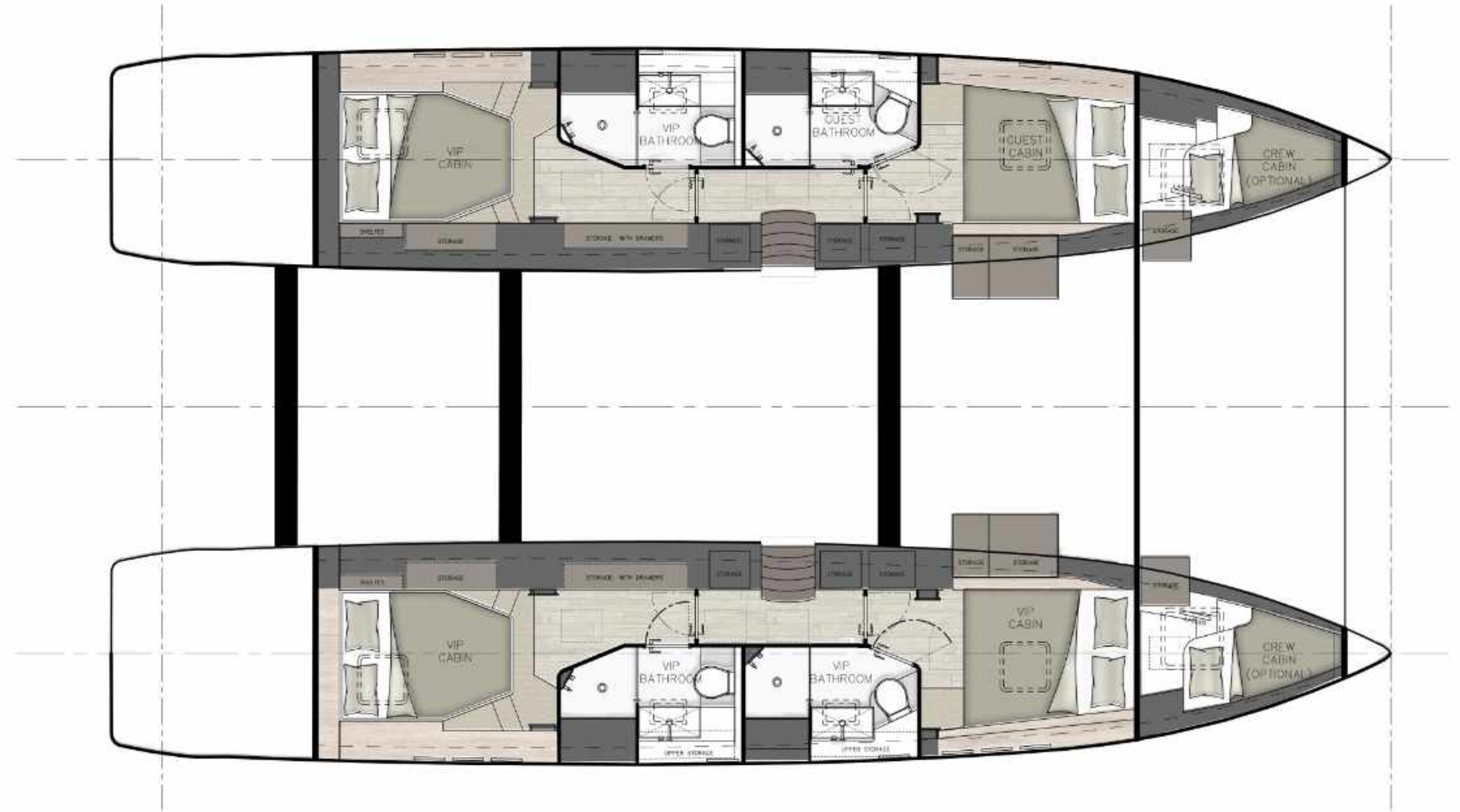

3 VIP cabins, 1 Guest cabin
2 Crew cabins (optional)



OMAYA 50 MATERIAL BOARD

EXTERIOR MAIN DECK

SUNPADS
silvertex white

UPHOLSTERY SOFA
crevin vita (imp) 07

TABLE
teak

COVERS
sunbrella cadet grey



ART COCKPIT CHAIRS
skagerak

FLOORING
artificial teak

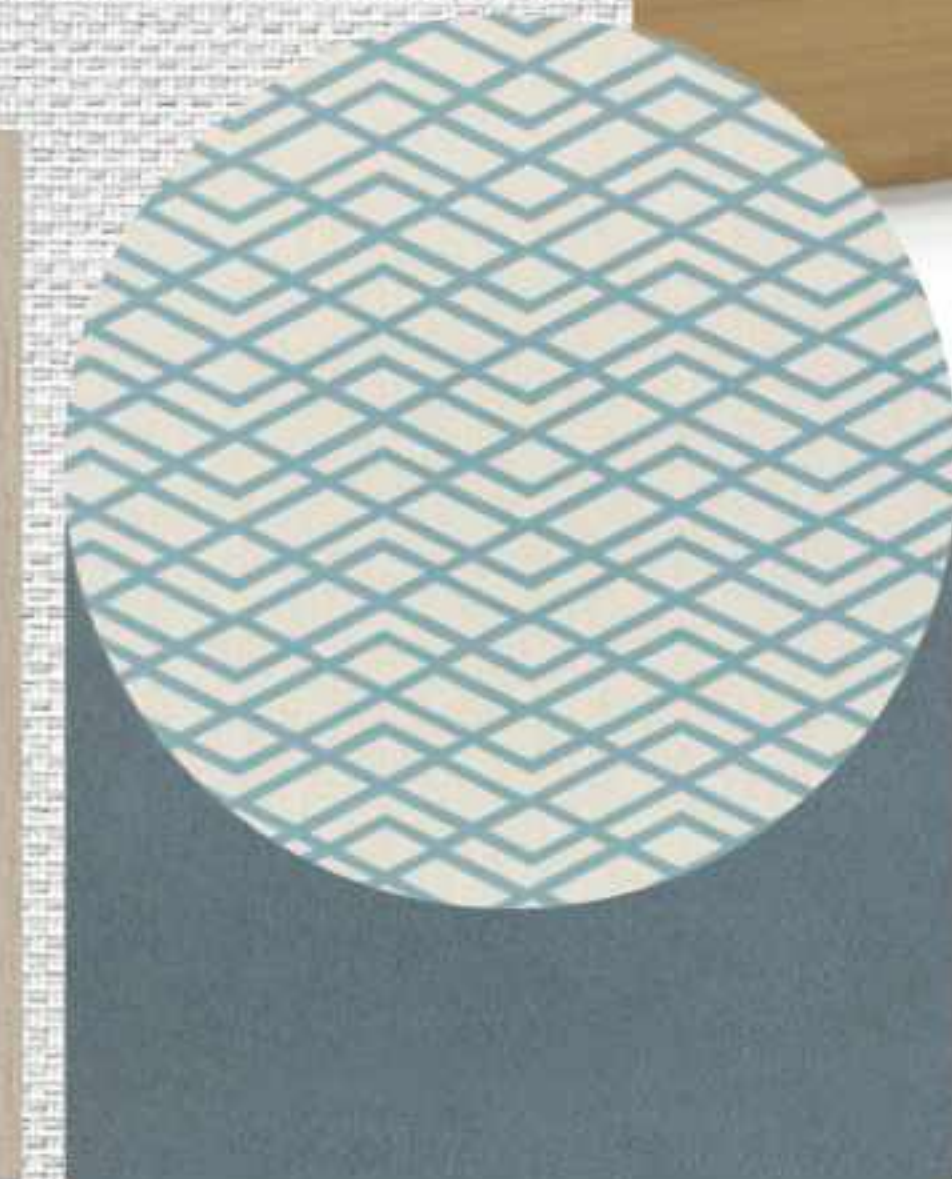

DECORATIVE PILLOWS
Arbi outdoor Atlantic

DECORATIVE PILLOWS
Calita outdoor SURF



Material boards on OMAYA Yachts can be customized according to the client's preferences, allowing each yacht to reflect the unique style and personality of its owner. This flexibility ensures that every OMAYA yacht is a true expression of luxury and individuality, tailored to meet the specific tastes and desires of each customer.



OMAYA 50 MATERIAL BOARD

FLY BRIDGE

SUNPADS UPHOLSTERY
silvertex white

UPHOLSTERY SOFA
crevin vita (imp) 07



SEATS
va varuste
silvertex white



COVERS
sunbrella cadet grey

FLOORING
artificial teak

DECORATIVE PILLOWS
Arbi outdoor Atlantic

DECORATIVE PILLOWS
Calita outdoor SURF

Material boards on Omayya Yachts can be customized according to the client's preferences, allowing each yacht to reflect the unique style and personality of its owner. This flexibility ensures that every Omayya yacht is a true expression of luxury and individuality, tailored to meet the specific tastes and desires of each customer.



OMAYA 50 MATERIAL BOARD

MAIN DECK SALOON

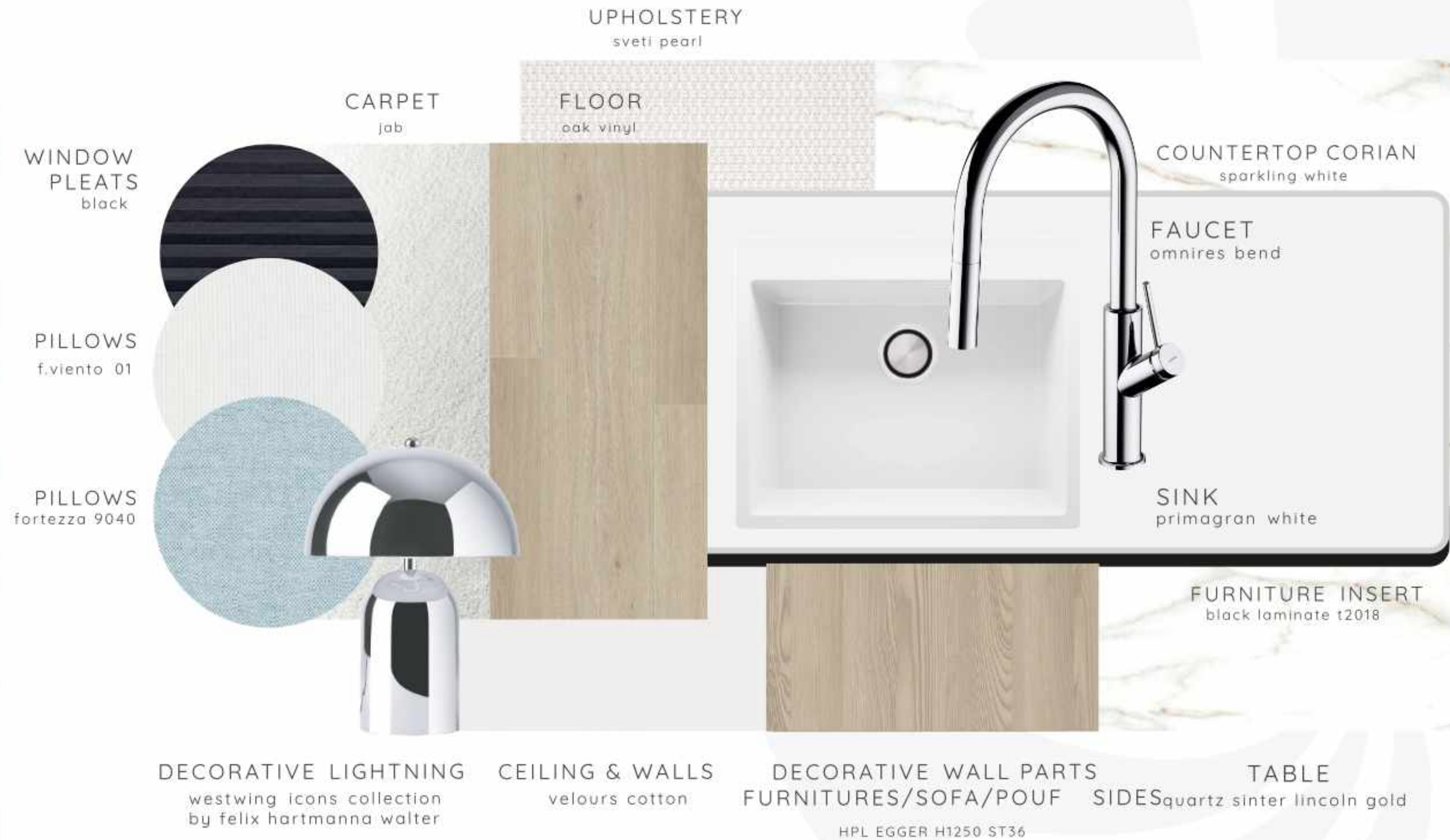

Material boards on Omay Yachts can be customized according to the client's preferences, allowing each yacht to reflect the unique style and personality of its owner. This flexibility ensures that every Omay yacht is a true expression of luxury and individuality, tailored to meet the specific tastes and desires of each customer.



OMAYA 50 MATERIAL BOARD

MASTER CABIN

COUNTERTOP CORIAN
sparkling white

CARPET
jab infinity

FLOOR
oak vinyl

WALL LAMP
astro ottavino

DOOR HANDLE
aprile kalmia

BESIDE LAMP
bcm stilo top 1

SOFA PILLOWS
supernova peyote

SOFA PILLOWS
cosmic moonbeam

SOFA UPHOLSTERY
f.viento 01

CEILING & WALLS
velours cotton

ROMAN BLINDS
notte white

BLANKET/PILLOWS
hefa - latl 800

BEDDING SET
supernova peyote

BED COVER SET
maldives linen

WALL & FURNITURES
HPL EGGER H1250 ST36

MIRROR
brown

Material boards on Omayya Yachts can be customized according to the client's preferences, allowing each yacht to reflect the unique style and personality of its owner. This flexibility ensures that every Omayya yacht is a true expression of luxury and individuality, tailored to meet the specific tastes and desires of each customer.



OMAYA 50 MATERIAL BOARD MASTER BATHROOM

DECORATIVE WALL

rehau gloss marmo 1970L

FURNITURE FRONTS

rehau gloss 1917L

COUNTERTOP CORIAN

sparkling white

SHOWER SET

omnires Y

DOOR HANDLE

aprile kalmia

MIRROR

classic silver

FAUCET

omnires Y

FURNITURE INSERTS

laminate noir absolu

SINK

mexen ava

WALLS

white laminate

DECORATIVE PORTAL

HPL EGGER H1250 ST36

ALUMINIUM BLINDS

silver

FLOORING

vinyl orbiton

Material boards on OMAYA Yachts can be customized according to the client's preferences, allowing each yacht to reflect the unique style and personality of its owner. This flexibility ensures that every OMAYA yacht is a true expression of luxury and individuality, tailored to meet the specific tastes and desires of each customer.



OMAYA 50 MATERIAL BOARD

GUEST CABINS

BEDDING SET
supernova castle rock

BED COVER SET
maldives linen

BED PILLOWS
mari frost

HEADBOARD
tunis 2333

CEILING & WALLS
velours paraffin

DOOR HANDLE
aprile kalmia

ROMAN BLINDS
natte white

WALLS
HPL EGGER H1250 ST36

CARPET
jab infinity

FLOOR
oak vinyl

BESIDE LAMP
bcm stilo top I

Material boards on Omayya Yachts can be customized according to the client's preferences, allowing each yacht to reflect the unique style and personality of its owner. This flexibility ensures that every Omayya yacht is a true expression of luxury and individuality, tailored to meet the specific tastes and desires of each customer.



OMAYA 50 MATERIAL BOARD GUEST BATHROOMS

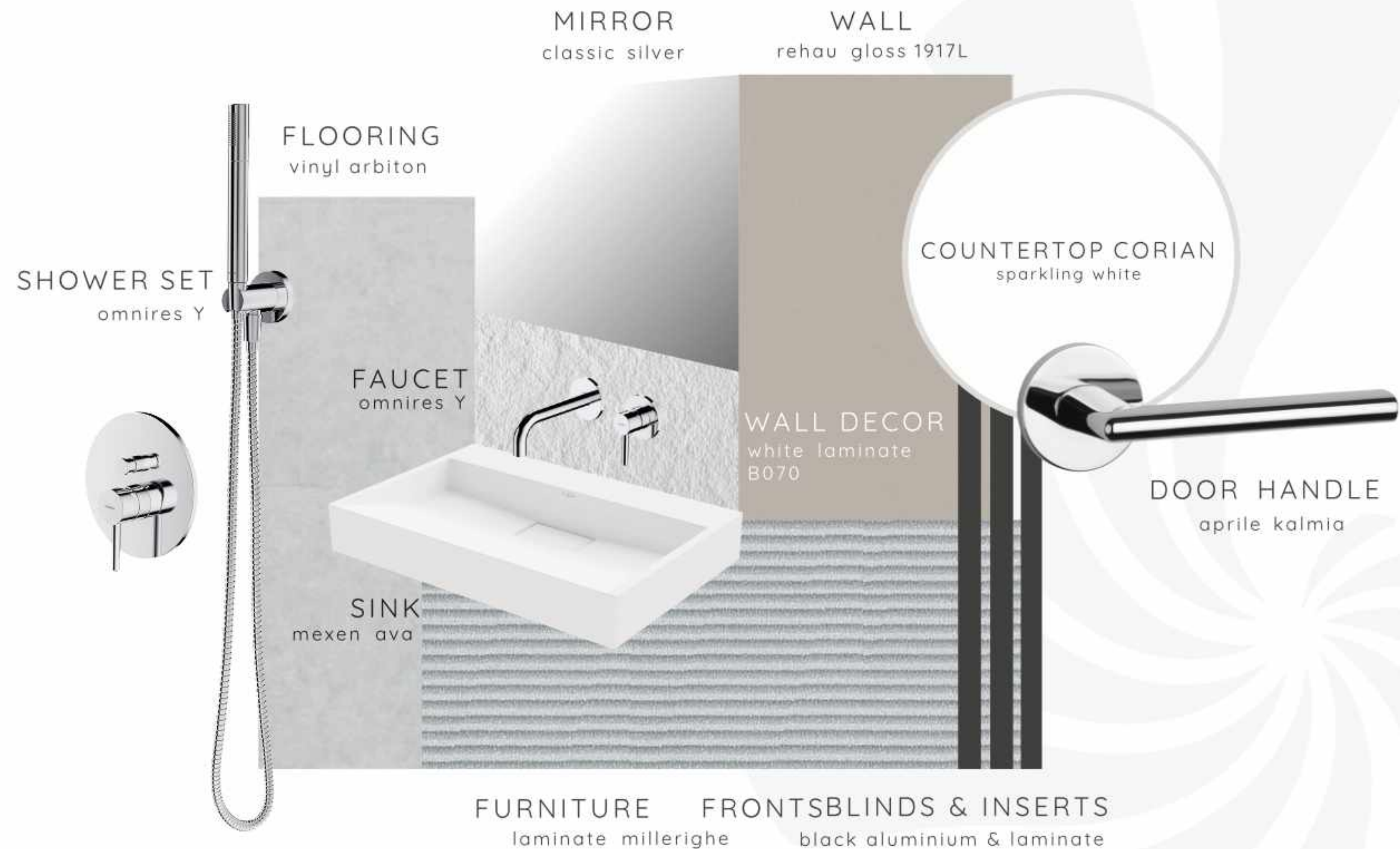

Material boards on Omayya Yachts can be customized according to the client's preferences, allowing each yacht to reflect the unique style and personality of its owner. This flexibility ensures that every Omayya yacht is a true expression of luxury and individuality, tailored to meet the specific tastes and desires of each customer.



OMAYA
YACHTS

www.omaya-yachts.com
info@omaya-yachts.com

All data in this document is subject to change and is not legally binding.